

Instructions for interchangeable Rotary Blades

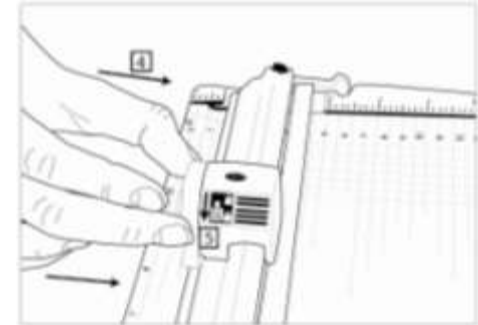

1. Slide the rotary blade cartridge switch to the unlock position.
2. Remove the clear cartridge cap by pulling it away from the rotary blade cartridge.
3. Simply tilt the clear cartridge cap downward to remove the Rotary Blade and replace with a new Rotary Blade. (Caution: Rotary Blade edge is sharp.)
4. Return clear cartridge cap to its original position on the rotary blade cartridge.
5. Slide the rotary blade cartridge switch to the lock position.

Instructions for the Mat Strip

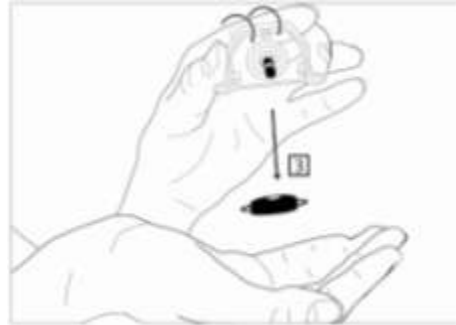
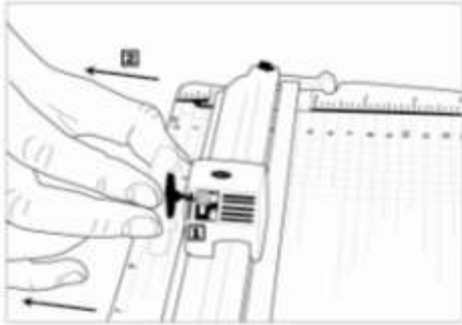
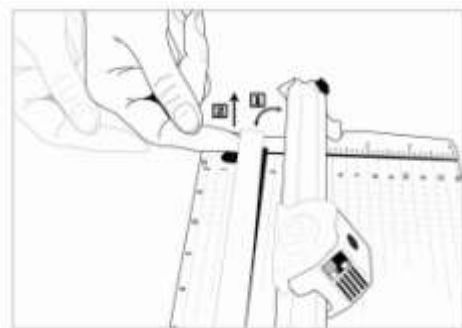

1. Lift the cutting arm.
2. Pull the Mat Strip out by means of the finger groove to lift and release.
3. Flip or rotate the Mat Strip to a new surface and replace the Mat Strip after all cutting surfaces are worn.